A photograph of a modern building facade with balconies featuring glass railings. The text is overlaid on the lower half of the image.

Assembly instruction Easy Glass Smart

rapa GmbH
Duisburger Str. 71
46446 Emmerich am Rhein



Telefon: +49 (0) 2822 53 75 57 5
E-Mail: info@schmiedekult.de
Shop: www.schmiedekult.de

Table of contents

Table of contents	2
Easy Glass Smart – Mounting	3-8
<u>Easy Glass Smart Mounting Smart F</u>	9-13
<u>Easy Glass Smart Side mounting Smart and Smart Y</u>	14-19

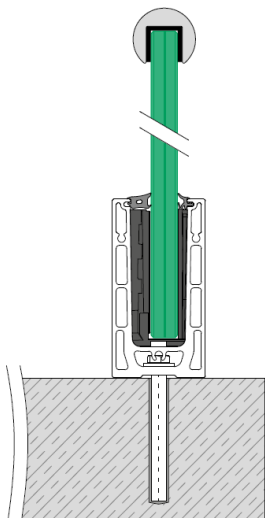

Easy Glass Smart – Mounting

1. Preparation of the assembly site

Before starting work, make sure that the installation site is adequately prepared. For this purpose, clean the place where you want to install your new railing and make sure that the surface is as even as possible. Subsequent leveling of unevenness is only possible to a limited extent and can impair stability.

2. Mounting the floor profiles

Please place the floor profiles on the floor at the position to be mounted. There should be a distance of 7 cm from the center of the floor profile to the concrete edge. Now place the profiles in a straight line, butt to butt. The joints should not form any perceptible gaps.

Make sure that the profiles are laid out so that the outer inner edge, which is provided with a small edge, faces outwards.

After you have aligned the profiles, drill through the holes that are already there or make drill marks on the floor. Then clean the drill holes thoroughly with a brush. Fasten the profiles with a suitable fastening material.

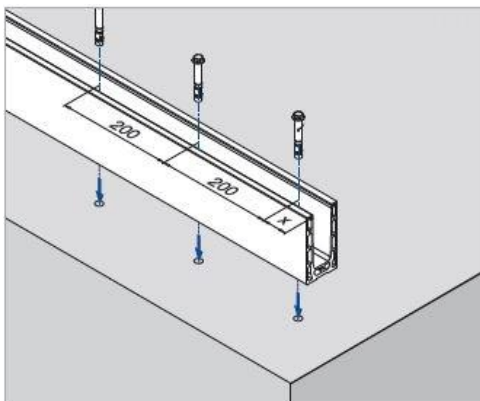
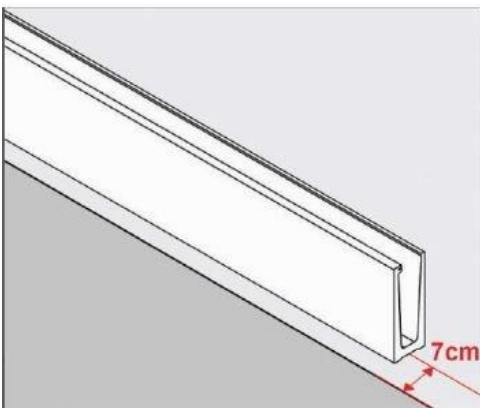

Note

Please use only suitable fastening material and always maintain the required minimum edge distances. In case of any uncertainties, please seek advice from expert personnel.

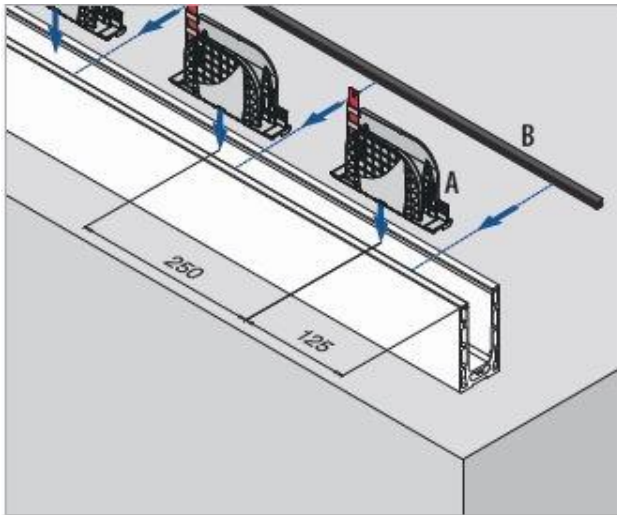

3. Mount the glass pane

Glue the thinner rubber gasket to the outer inner side of the bottom profile and place the "inlays" in the profile at the appropriate places

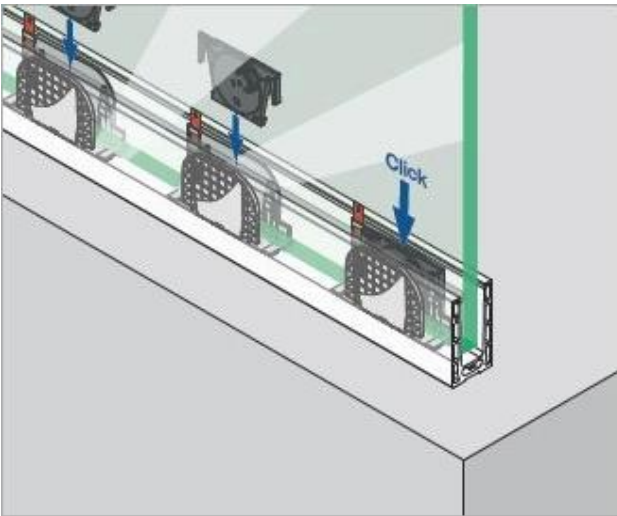

Then place the glass pane in the "inlays". To fix the glass, insert the "discs" between the glass and the "inlays" until they click into place.

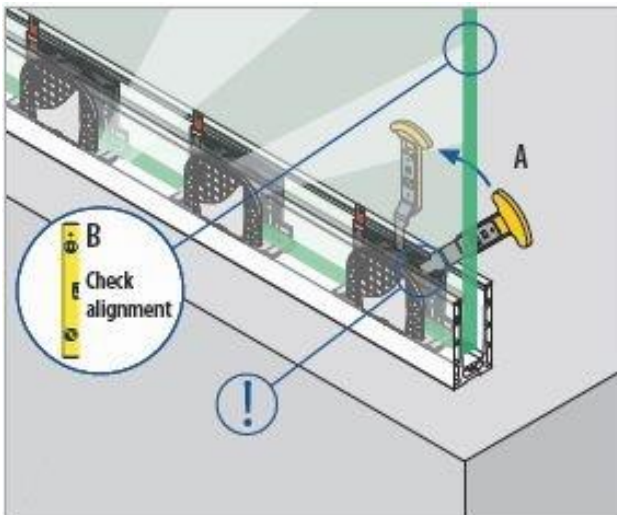

Then tighten the "discs" clockwise using the tool provided to hold the glass in place.

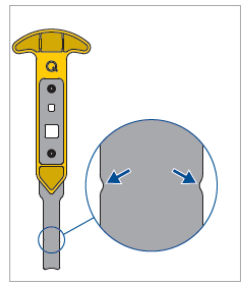
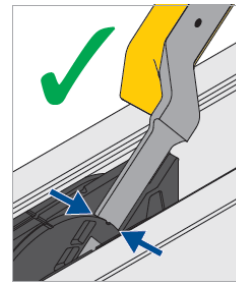
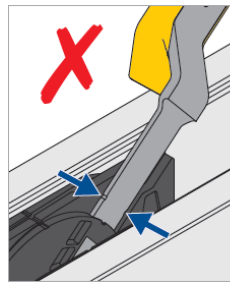

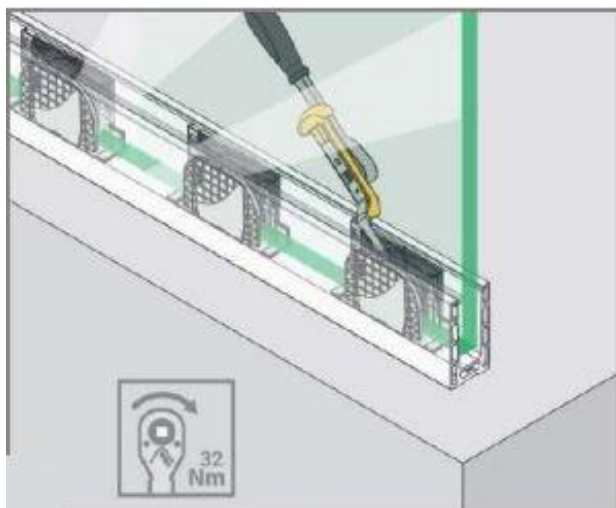

For this purpose, please observe the correct setting of the torque wrench (Nm32).

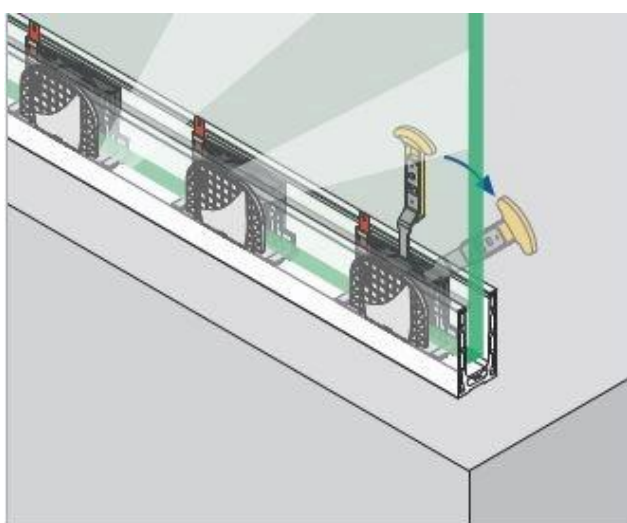

4. Adjusting the glass pane

Discs still need to be aligned. If this is the case, the "discs" concerned must be loosened again with the counterclockwise tool.

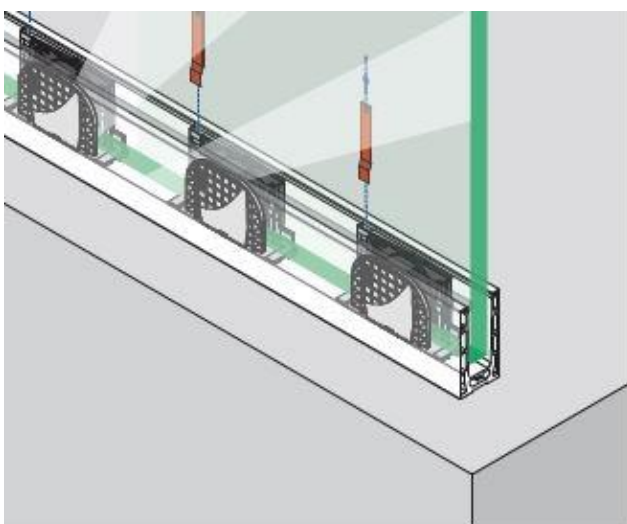

Now loosen the locking pin of the inlay concerned. In order to be able to adjust the angle of the glass pane, move the inlay with the aid of the tool supplied.

After the adjustment, fix the glass pane again. Please note the correct setting of the torque wrench.

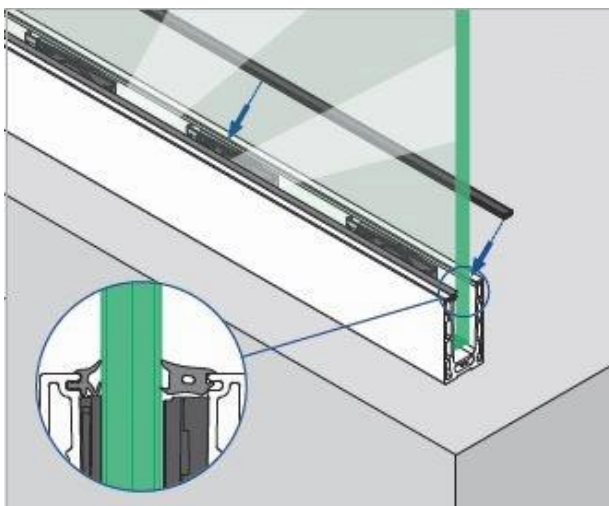
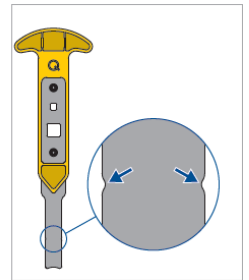
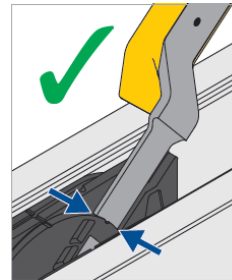
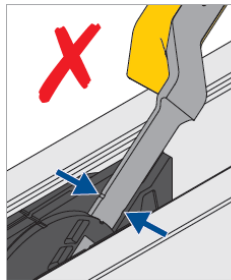
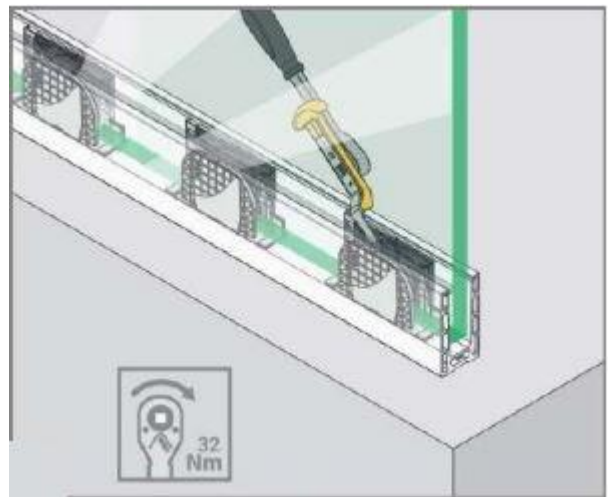
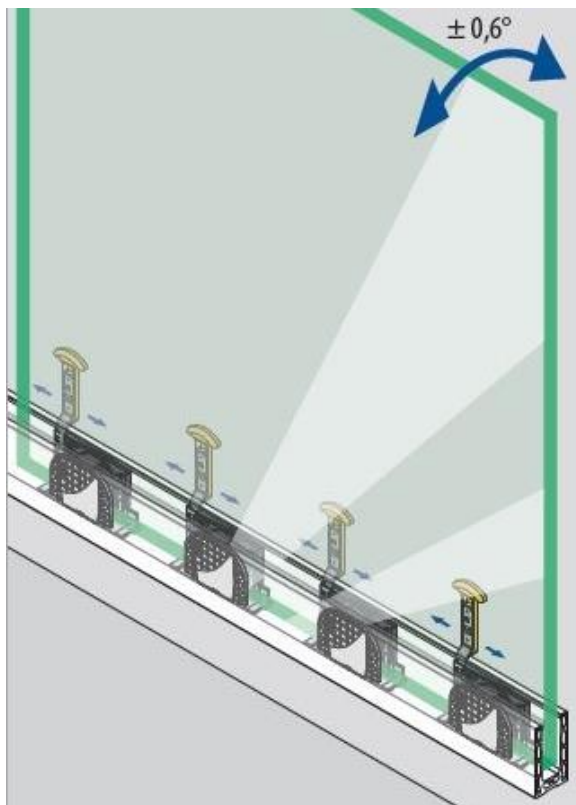

5. Insert rubber seal

Glue the thick rubber gasket to the inner inside of the bottom profile.

6. Mounting the handrail (grooved tube)

The grooved tube is mounted by attaching the rubber profile to the upper edge of the glass pane. As with the rubber seal, this can be associated with some resistance. This can be counteracted with some water and washing-up liquid.

Please make sure that the grooved tube does not come into contact with other metals, such as iron or steel, as foreign particles can lead to surface corrosion in this material.

Then press the handrail tube onto the rubber profile. To extend the handrail tube if necessary, use the tube connectors, which can be easily fixed to the tubes using adhesive.

Then glue the end caps into the ends of the grooved tubes.

After installation, it is also important to clean and maintain the all-glass railing appropriately.

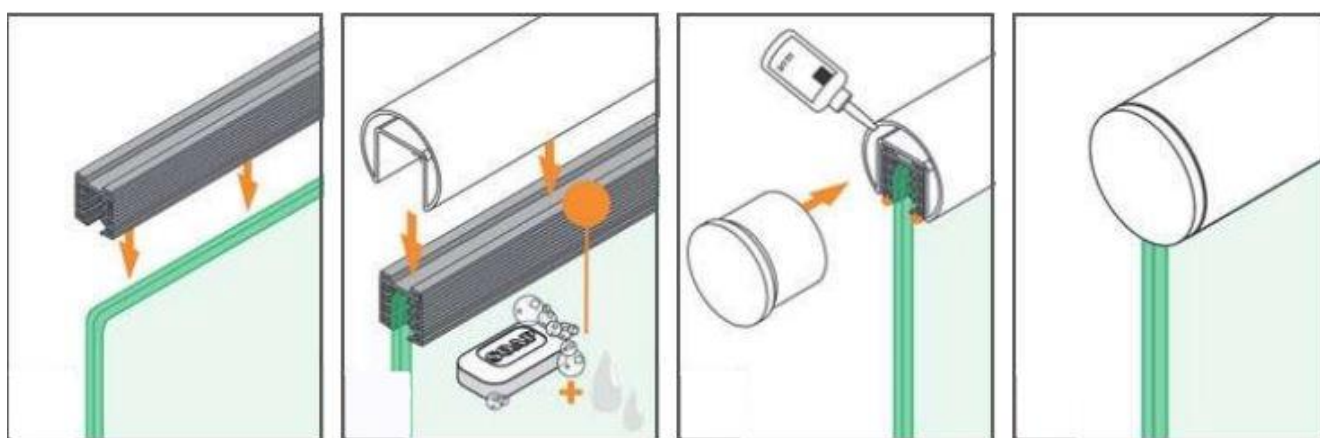

7. Cleaning of the handrail tube/profiles

Light dirt and finger marks, can be removed with warm water and a soft microfiber cloth. Please be careful not to use cloths that have been in contact with other metals. A small drop of detergent, can strengthen the cleaning and is not dangerous for the material.

If you want to use detergents for handrails, the material should be retreated with cold water. To avoid lime stains, demineralized water is a good choice. Dry the handrail well with a clean, soft cloth.

Avoid:

- Cleaning agents containing chlorine
- Bleach
- scouring agents
- Cleaning for silver

8. Cleaning the glass pane

After installing the glass pane, it should be cleaned with a soft cloth and conventional window cleaning agent. If you are still in the middle of your construction phase, make sure that soiling with aggressive agents of any kind (e.g. plaster) is urgently avoided. Should contamination nevertheless occur, clean it immediately with sufficient clean water as well as an appropriate glass cleaning agent.

Make sure to use cloths that are clean and free of any protective particles. These can cause unwanted scratches. Aggressive household agents should generally not be used!

Easy Glass Smart Mounting Smart F

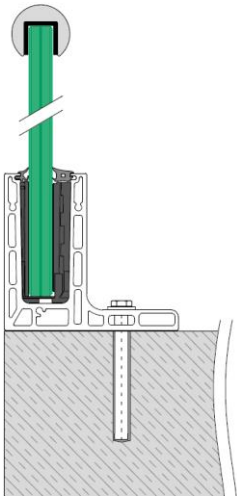

1. Preparation of the assembly site

Before starting work, make sure that the installation site is adequately prepared. For this purpose, clean the place where you want to install your new railing and make sure that the surface is as even as possible. Subsequent leveling of unevenness is only possible to a limited extent and can impair stability.

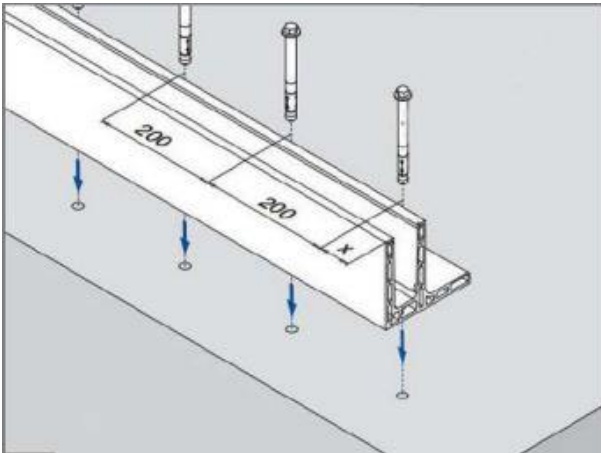

2. Mounting the floor profiles

Due to the practical F-shape of the floor profiles, you can attach the profile directly to the floor edge. Place the profiles in a straight line, butt to butt, at the floor edge so that there are no noticeable gaps. When the profiles are lined up straight, mark where you want to place the holes through the existing holes. Then clean the drill holes with a brush, the drill or blow them out carefully.

Note

Please use only suitable fastening material and always maintain the required minimum edge distances. In case of any uncertainties, please seek advice from expert personnel.

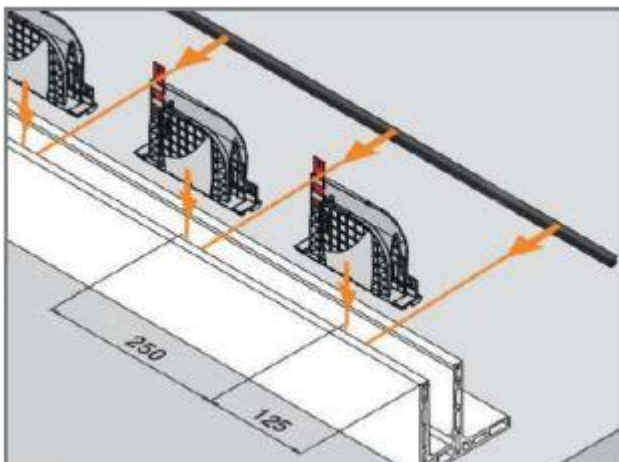

3. Mount glass pane

Glue the thinner rubber gasket to the outer inside of the bottom profile and place the "inlays" in the appropriate places in the profile.

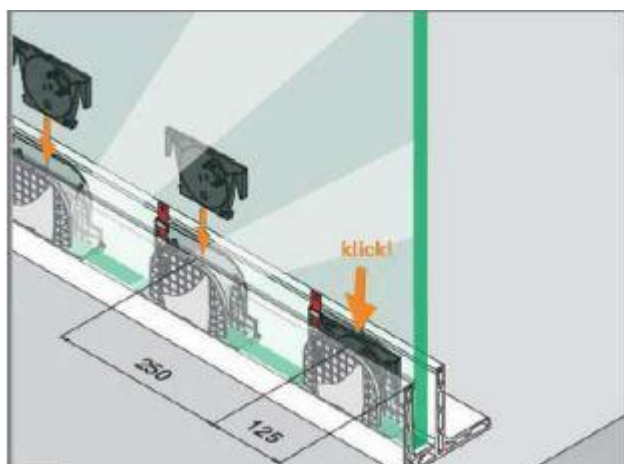

Then place the glass pane in the "inlays". To fix the glass, insert the "discs" between the glass and the "inlays" until they click into place.

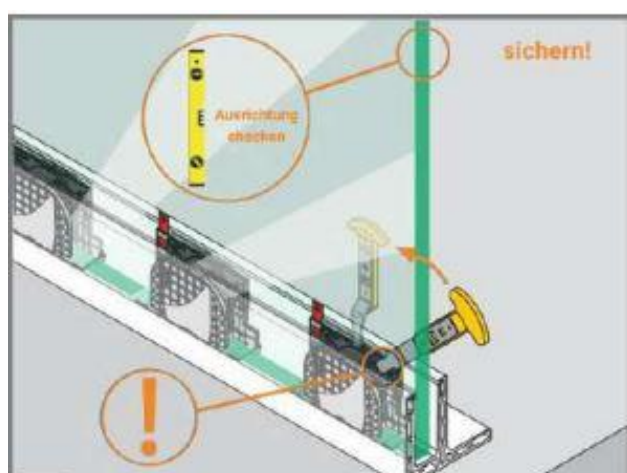

Then tighten the "discs" clockwise using the tool provided to hold the glass in place.

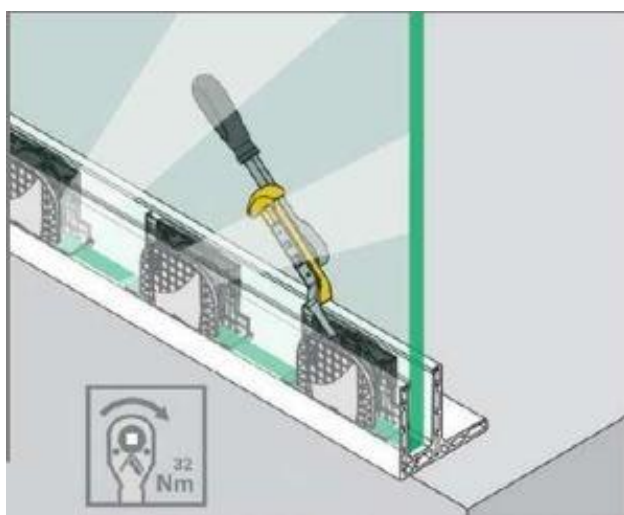
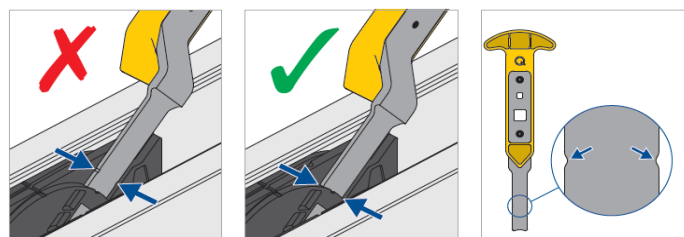

For this purpose, please observe the correct setting of the torque wrench



(Nm32).

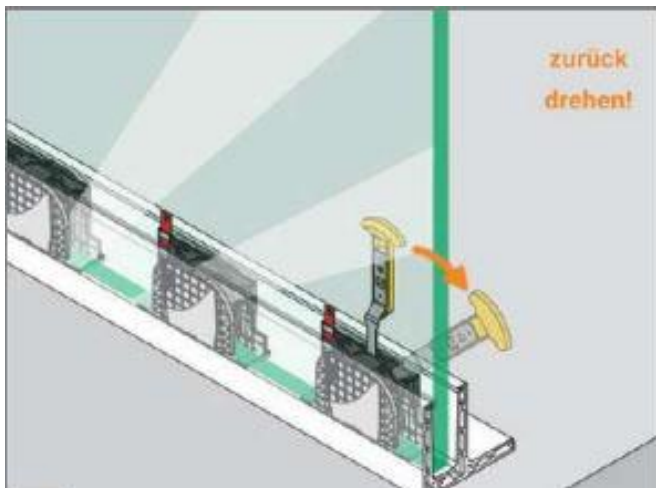

4. Adjust glass pane

If you discs still need to be aligned. If this is the case, the "discs" concerned must be loosened again with the tool in an anticlockwise direction.

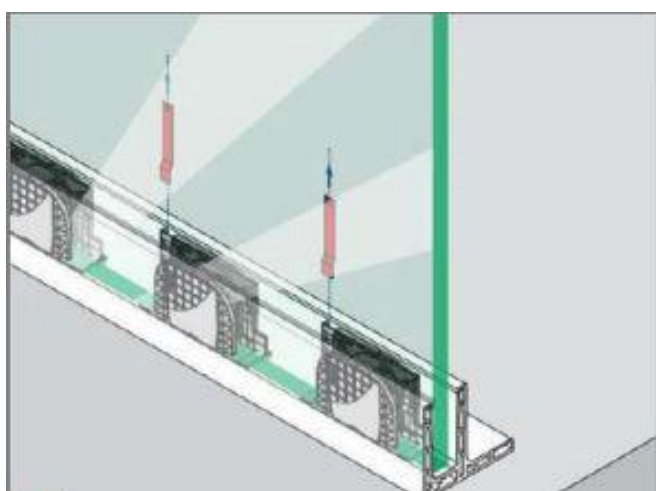

Now loosen the locking pin of the inlay concerned. In order to be able to adjust the angle of the glass pane, move the inlay with the aid of the the tool supplied.

After the adjustment, fix the glass pane again.

For this purpose, please observe the correct setting of the torque wrench (32Nm).

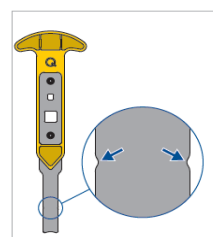
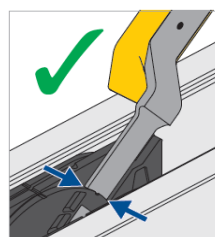
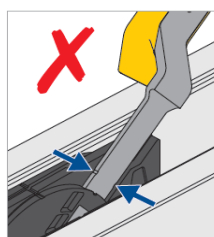
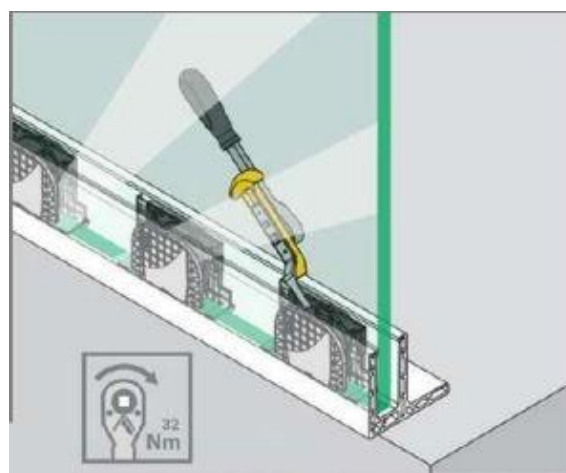
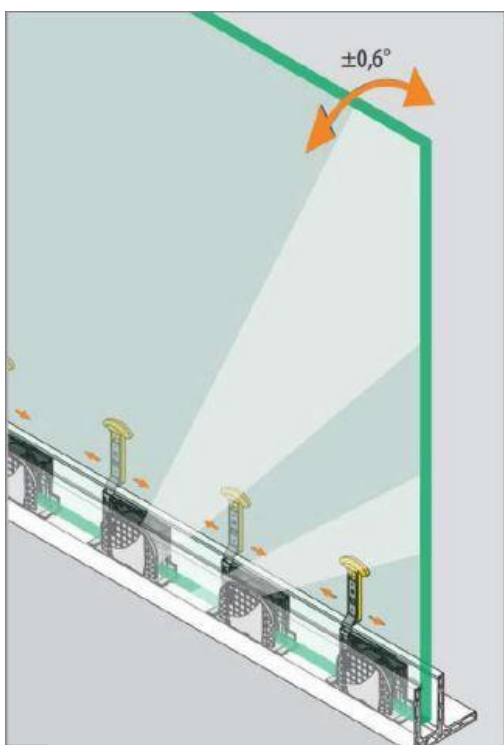

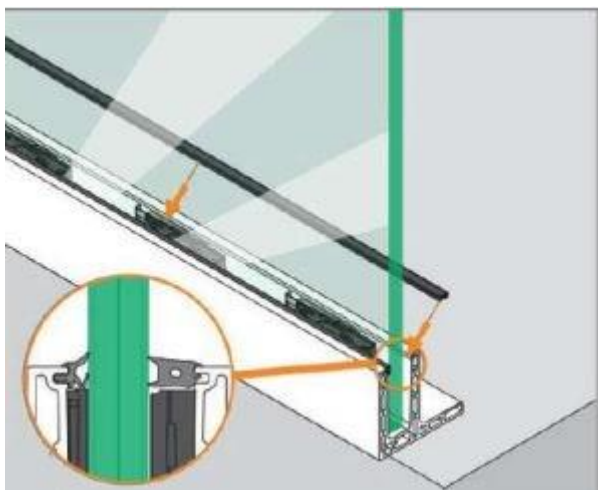

5. Insert rubber seal

Glue the thick rubber gasket to the inner inside of the bottom profile.

6. Mount handrail (grooved tube)

The grooved tube is mounted by fixing the rubber profile to the upper edge of the glass pane. This can be associated with some resistance, as with the rubber seal. This can be counteracted with water and washing-up liquid.

Please make sure that the grooved tube does not come into contact with other metals, such as iron or steel, as foreign particles can lead to surface corrosion in this material.

Then press the handrail tube onto the rubber profile. To extend the handrail tube if necessary, use the tube connectors, which can be easily fixed to the tubes using adhesive.

Then glue the end caps into the ends of the grooved tubes.

After installation, it is also important to clean and maintain the all-glass railing appropriately.

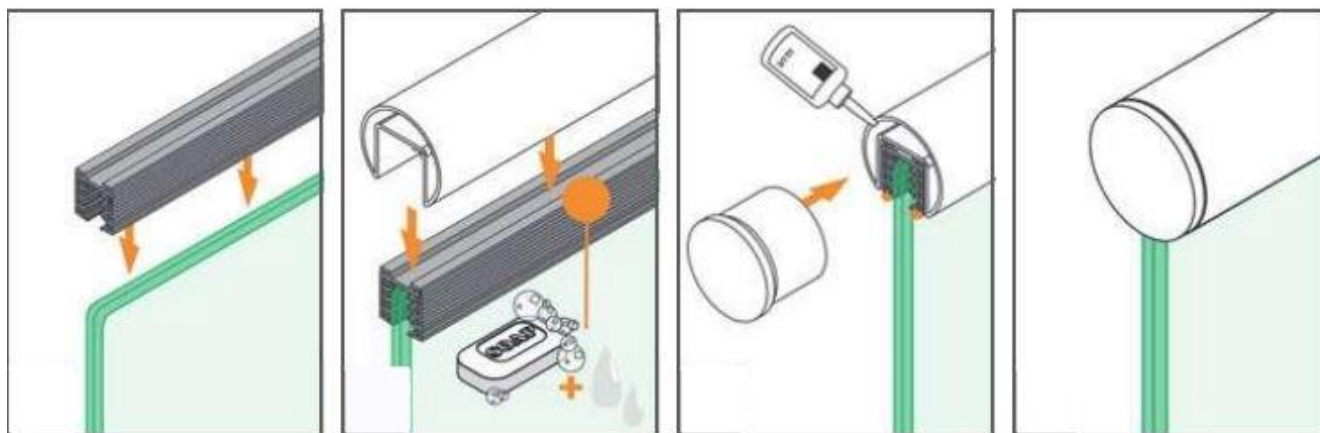

7. Cleaning of the handrail tube/profiles

Light dirt and finger marks, can be removed with warm water and a soft microfiber cloth. Please be careful not to use cloths that have been in contact with other metals. A small drop of detergent, can strengthen the cleaning and is not dangerous for the material. If you want to use detergents for handrails, the material should be retreated with cold water. To avoid lime stains, demineralized water is a good choice. Dry the handrail well with a clean, soft cloth.

Avoid:

- Cleaning agents containing chlorine
- Bleach
- scouring agents
- Cleaning for silver

8. Cleaning the glass pane

After installing the glass pane, it should be cleaned with a soft cloth and conventional window cleaning agent. If you are still in the middle of your construction phase, make sure that soiling with aggressive agents of any kind (e.g. plaster) is urgently avoided. Should contamination nevertheless occur, clean it immediately with sufficient clean water as well as an appropriate glass cleaning agent.

Make sure to use cloths that are clean and free of any protective particles. These can cause unwanted scratches. Aggressive household agents should generally not be used!

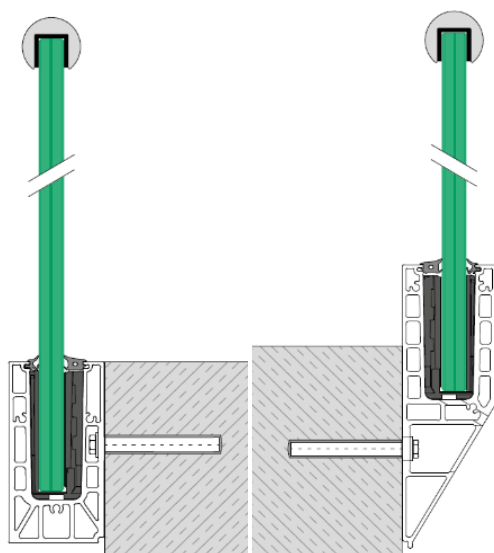

Easy Glass Smart Side mounting Smart and Smart Y

1. Preparation of the assembly site

Before starting work, make sure that the installation site is adequately prepared. For this purpose, clean the place where you want to install your new railing and make sure that the surface is as even as possible. Subsequent leveling of unevenness is only possible to a limited extent and can impair stability.

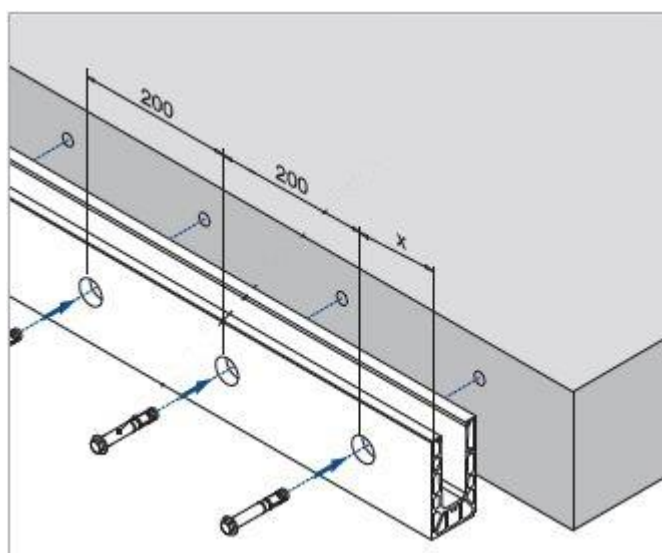

2. Mounting the side profiles

Lay out the side profiles on the floor at the position to be mounted. Make sure that the flat outer side of the profile (with the large holes) is on the outside! The side with the small holes is therefore held against the side of the concrete slab and screwed on.

Place the profiles butt to butt in a straight line and prevent palpable gaps.

Once you have the profiles lined up straight, either drill through the existing holes or mark them. Clean the drill holes thoroughly with a brush, the drill bit or blow them out carefully.

Fasten the profiles with the appropriate fastening material. Again, make sure that the side with the small holes is screwed against the concrete slab.

Note

Please use only suitable fastening material and always maintain the required minimum edge distances. In case of any uncertainties, please seek advice from expert personnel.

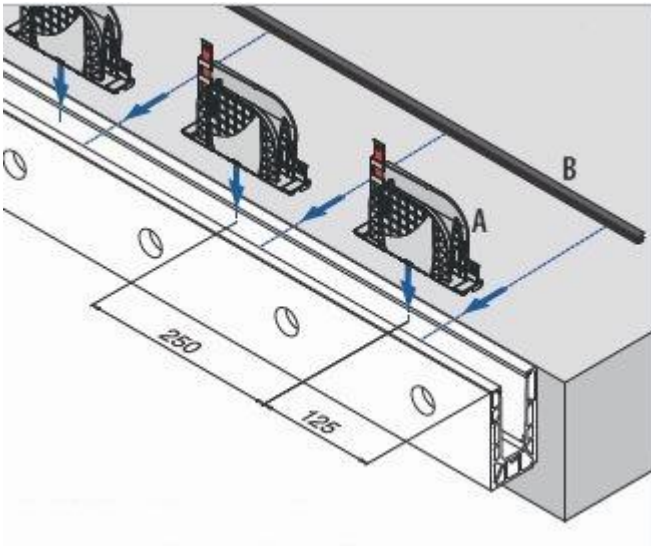

3. Mount glass pane

Glue the thinner rubber gasket to the outer inside of the side profile and place the "inlays" in the appropriate places in the profile.

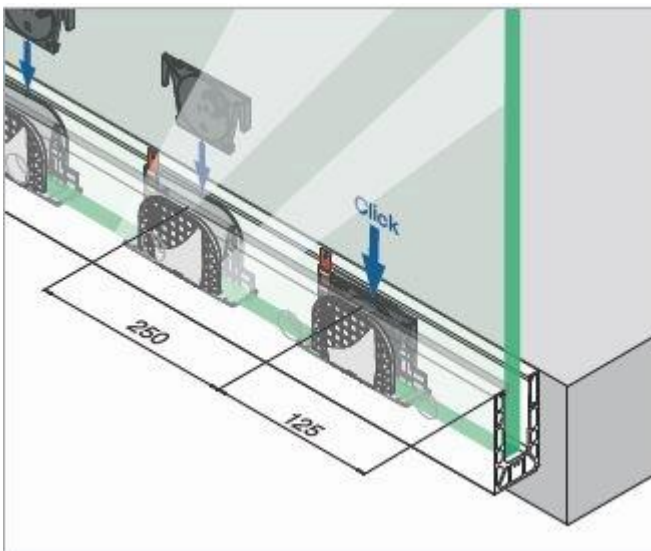

Then place the glass pane in the "inlays". To fix the glass, insert the "discs" between the glass and the "inlays" until they click into place.

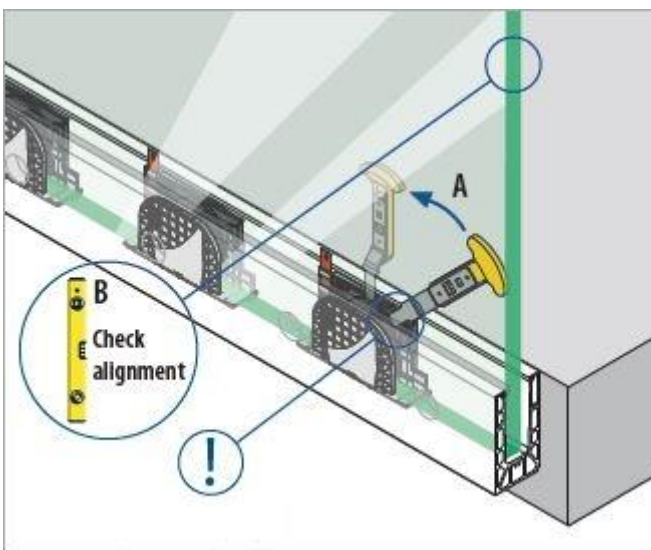

Then tighten the "discs" clockwise using the tool provided to hold the glass in place.

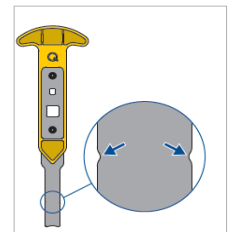
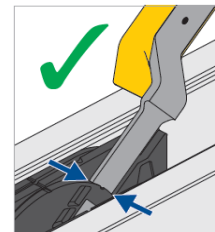
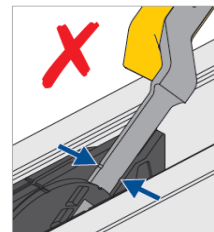

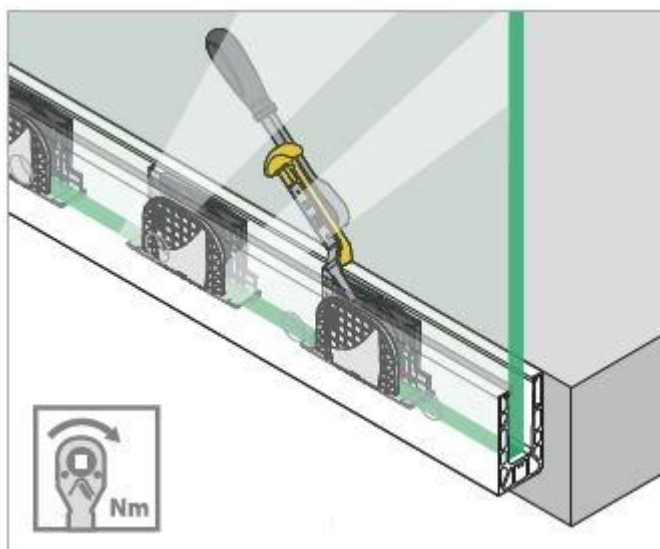

For this purpose, please observe the correct setting of the torque wrench (Nm32).

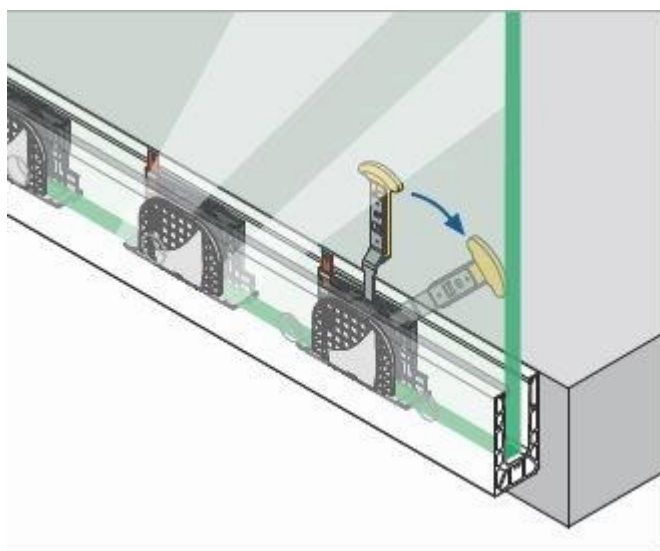

4. Adjust glass pane

If the discs still need to be aligned. If this is the case, the affected "discs" must be loosened again with the tool counterclockwise.

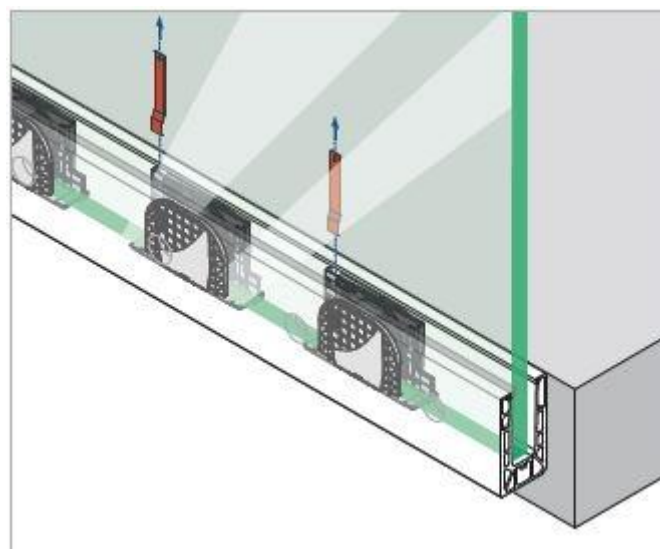

Now loosen the locking pin of the inlay concerned. In order to be able to adjust the angle of the glass pane, move the inlay with the aid of the the tool supplied.

After the adjustment, fix the glass pane again.

For this purpose, please observe the correct setting of the torque wrench (32Nm).

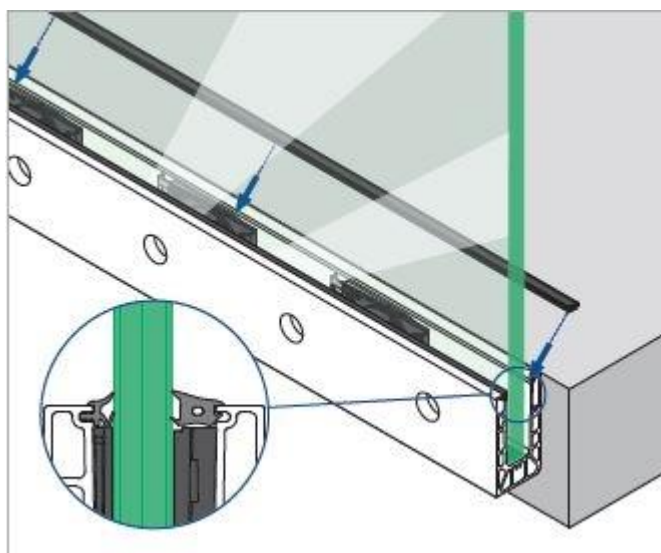
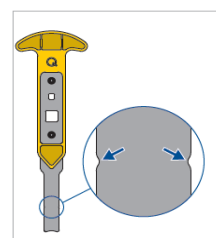
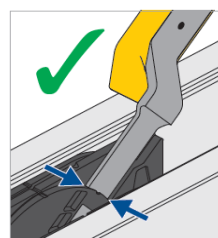
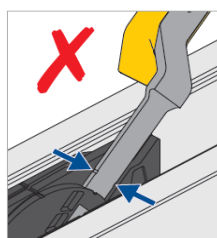
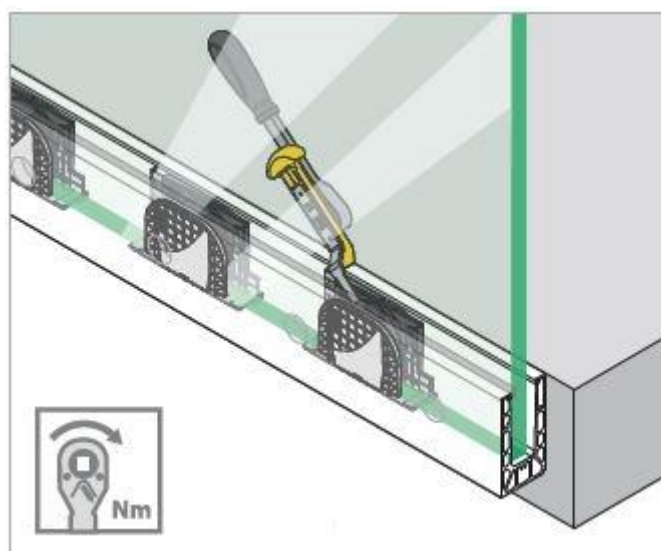
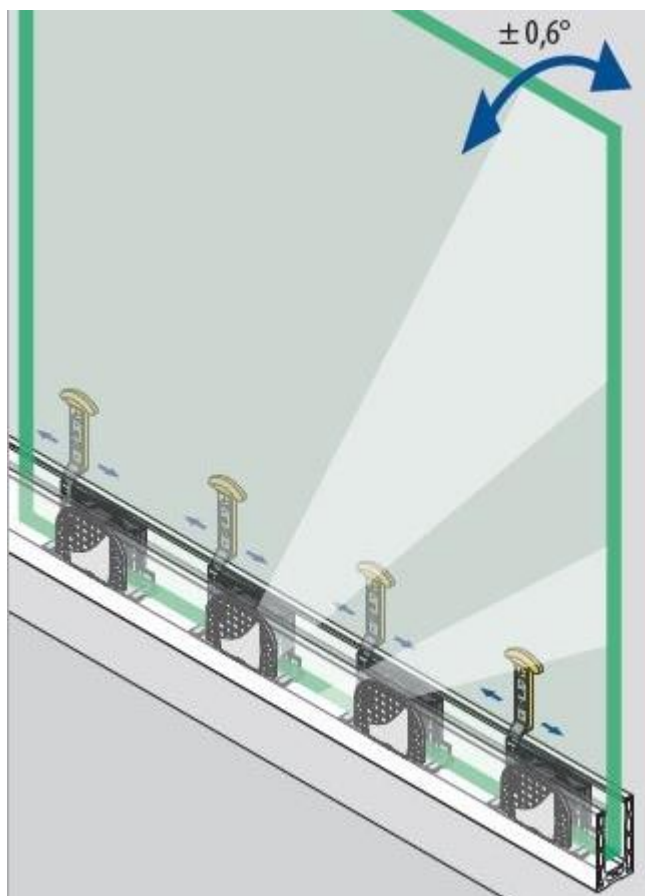

5. Insert rubber seal

Glue the thick rubber gasket to the inner inside of the bottom profile.

Then attach the glare plugs to the holes to prevent rainwater or dirt from entering.

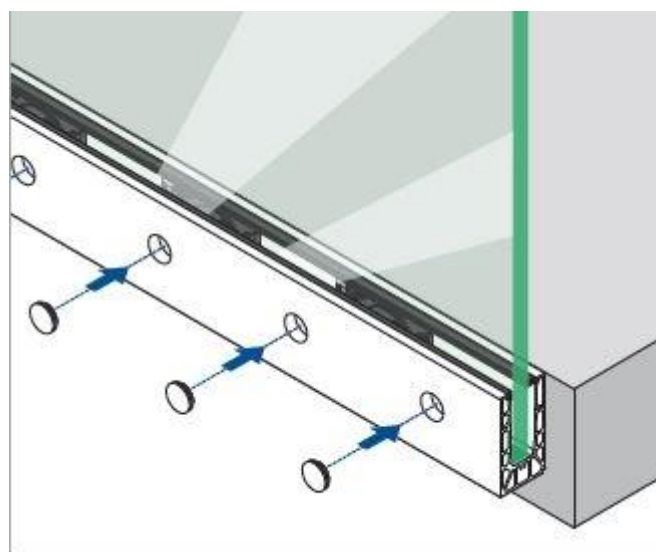

6. Mounting the handrail (grooved tube)

The grooved tube is mounted by attaching the rubber profile to the upper edge of the glass pane. As with the rubber seal, this can be associated with some resistance. This can be counteracted with some water and washing-up liquid.

Please make sure that the grooved tube does not come into contact with other metals, such as iron or steel, as foreign particles can lead to surface corrosion in this material.

Then press the handrail tube onto the rubber profile. To extend the handrail tube if necessary, use the tube connectors, which can be easily fixed to the tubes using adhesive.

Then glue the end caps into the ends of the grooved tubes.

After installation, it is also important to clean and maintain the all-glass railing appropriately.

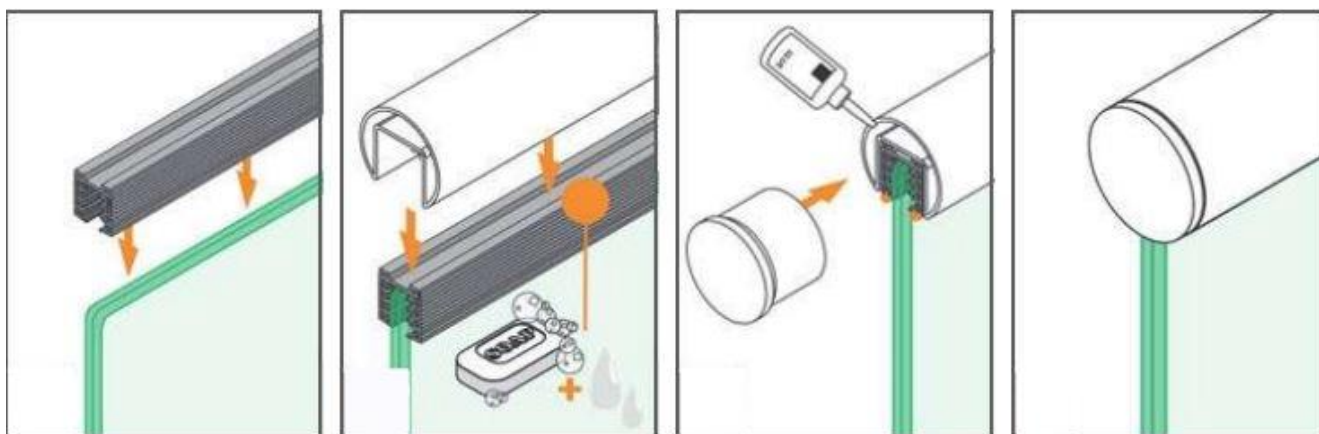

7. Cleaning of the handrail tube/profiles

Light dirt and finger marks, can be removed with warm water and a soft microfiber cloth. Please be careful not to use cloths that have been in contact with other metals. A small drop of detergent, can strengthen the cleaning and is not dangerous for the material. If you want to use detergents for handrails, the material should be retreated with cold water. To avoid lime stains, demineralized water is a good choice. Dry the handrail well with a clean, soft cloth.

Avoid:

- Cleaning agents containing chlorine
- Bleach
- scouring agents
- Cleaning for silver

8. Cleaning the glass pane

After installing the glass pane, it should be cleaned with a soft cloth and conventional window cleaning agent. If you are still in the middle of your construction phase, make sure that soiling with aggressive agents of any kind (e.g. plaster) is urgently avoided. Should contamination nevertheless occur, clean it immediately with sufficient clean water as well as an appropriate glass cleaning agent.

Make sure to use cloths that are clean and free of any protective particles. These can cause unwanted scratches. Aggressive household agents should generally not be used!